

STACEY DEVELOPMENTS - UNIT FLOOR PLAN - 1E

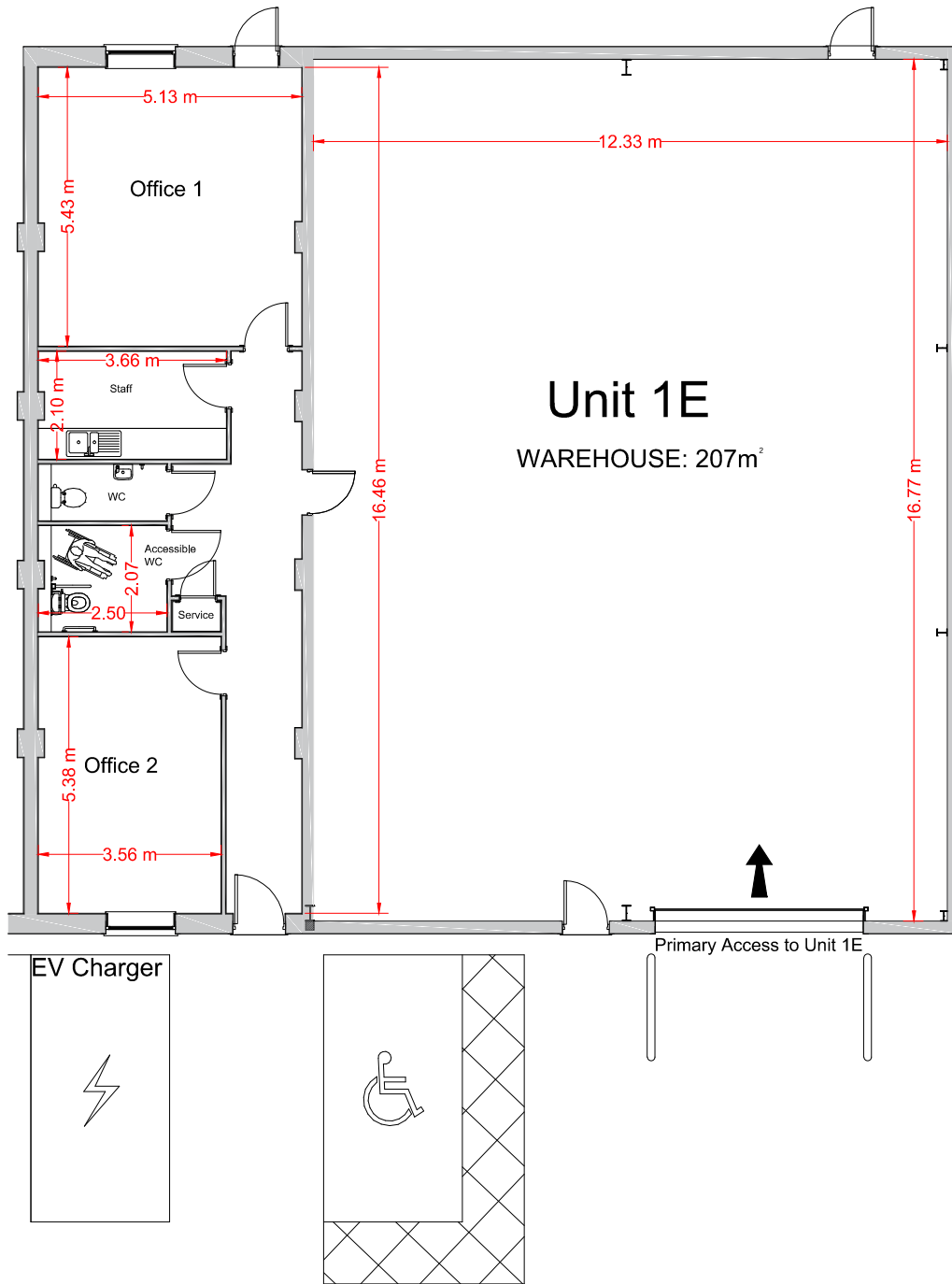

Unit Size

Unit 1E, Stacey's Industrian Yard, Tadley, Hampshire, RG26 3PX		
Office 1	5.43m x 5.13m	27.8 m <sup>2</sup> (299 ft <sup>2</sup> )
Office 2	5.38m x 3.56m	19.1 m <sup>2</sup> (206 ft <sup>2</sup> )
Warehouse	16.77m x 12.33m	207 m <sup>2</sup> (2228 ft <sup>2</sup> )
1st Floor	16.46m x 5.13m	84.4 m <sup>2</sup> (908 ft <sup>2</sup> )
Overall Unit (excluding 1st Floor)		291.4 m <sup>2</sup> (3136 ft <sup>2</sup> )

Key Features of Unit 1E.

- 3Nr Solar Panels
- EV Charging Point
- 3 Phase Electric Supply
- EPC Rating A
- Roller Shutter Door Access - 4m High and 4.05m Wide
- Wide Ranging Site CCTV, including ANPR Camera
- Phone Lines & Internet Connection
- DDA Compliant
- Fitted Kitchen

